

WARNING:



RISK OF FIRE AND ELECTRICAL SHOCK. FIXTURE MUST BE INSTALLED BY A QUALIFIED ELECTRICIAN ONLY IN ACCORDANCE WITH NATIONAL, LOCAL BUILDING AND ELECTRICAL CODES. DISCONNECT POWER AT ELECTRICAL PANEL BEFORE SERVICING.

14124 INSTALLATION INSTRUCTIONS FOR: DEEP REGRESSED LED RECESSED DOWNLIGHT

Please read all instructions prior to installation and keep for future reference!

1. Thoroughly read and understand all instructions before beginning luminaire installation.
2. Consult a qualified electrician to ensure the correct branch circuit conductor is used.
3. Installation and operation should be performed by a qualified electrician or technician in accordance with applicable local codes.
4. To prevent the risk of electric shock, ensure the main power source is turned off before wiring or soldering sections of the product.
5. To avoid fire or electric shock, install these kits only in luminaires that meet the construction features and dimensions specified in the provided photographs or drawings. Ensure the input rating of the recessed kit does not exceed that of the luminaire.
6. Confirm that all fixture connections are properly secured and grounded to prevent potential electrical shocks.
7. To prevent damage or abrasion to the wiring, avoid exposing it to the edges of sheet metal or other sharp objects. Do not create or modify any open holes in the enclosure of wiring or electrical components during installation.



For New Construction Applications:

Frame Kit (Order separately)

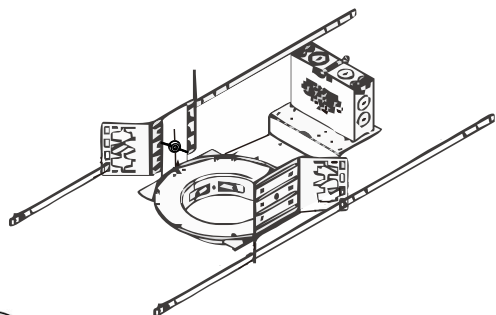

A

Recessed Kit Contents:

1. LED Engine
2. Reflector
3. LED Driver Box
4. Standard Clips
4pcs

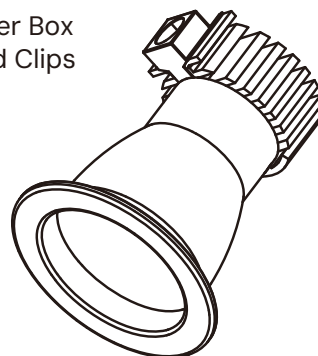

B

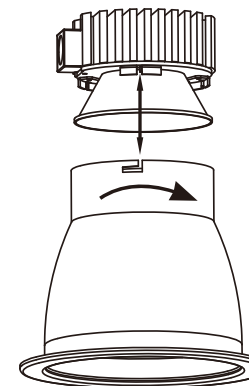

Note: When the LED engine and reflector are separate, please assemble them as follows: Slide the trim into place by rotating it clockwise.

WARNING: RISK OF FIRE AND ELECTRICAL SHOCK. FIXTURE MUST BE INSTALLED BY A QUALIFIED ELECTRICIAN ONLY IN ACCORDANCE WITH NATIONAL, LOCAL BUILDING AND ELECTRICAL CODES. DISCONNECT POWER AT ELECTRICAL PANEL BEFORE SERVICING.



INSTALLATION

Note: This recessed kit is voltage-specific. Please verify the correct voltage before installation.

For New Construction Applications: Start at Step 1.

For Remodel Applications: Start at Step 3.

Step 1: Install the housing frame kit in the ceiling. Adjust the horizontal position by sliding the housing along the bar hangers.

Step 2: Cut an opening in the ceiling according to the mounting frame diameters:

- 4-inch frame: Fits openings between 4" and 4.7"
- 6-inch frame: Fits openings between 6" and 6.7"
- 8-inch frame: Fits openings between 7.7" and 8.4"
- 10-inch frame: Fits openings between 10" and 10.7"

Step 3: Install the driver box into the junction box. For remodel applications, remove the J-box supply wires and any existing driver or ballast.

Step 4: Complete the wiring.

Step 5: Close the J-box and secure the driver box to the ceiling with screws. Attach the safety hook to the bracket hole.

Step 6: If the existing mounting frame lacks clips, install 4 clips as needed.

Step 7: Connect the black connector from the LED engine to the black connector at the end of the flex conduit on the driver box. Then, insert it into the LED engine's opening.

Step 8: Install the LED downlight into the ceiling. Restore power once installation is complete.

Remark: Ensure that the mounting frame can support the weight of the LED downlight. After installation, attach the provided lamping replacement and cautionary labels from the retrofit kit package to the light fixture. These labels must remain visible during relamping and after installation.

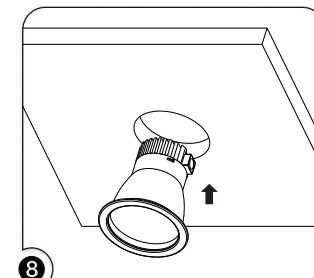
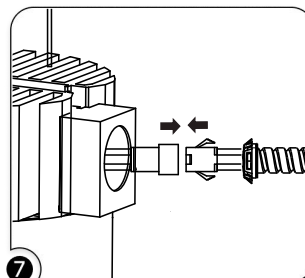
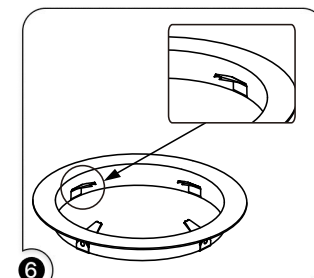
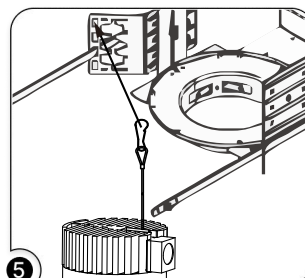
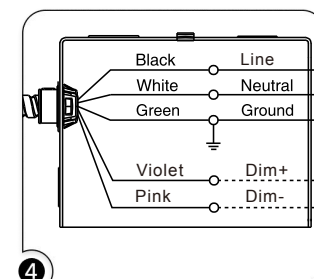
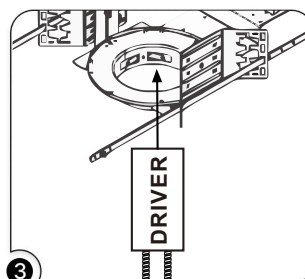
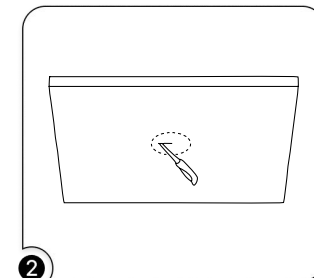
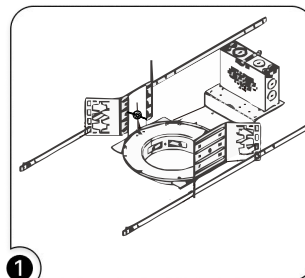

WARNING: RISK OF FIRE AND ELECTRICAL SHOCK. FIXTURE MUST BE INSTALLED BY A QUALIFIED ELECTRICIAN ONLY IN ACCORDANCE WITH NATIONAL, LOCAL BUILDING AND ELECTRICAL CODES. DISCONNECT POWER AT ELECTRICAL PANEL BEFORE SERVICING.

FRAME KIT (New Construction)

Available for 4/6/8/10"

Step 1: Bend the brackets on the housing frame as shown in Figure 1.

Note: The bending length will vary depending on your specific installation requirements.

Step 2: Secure the brackets of the housing frame with screws as illustrated. Refer to Figure 2 for wooden ceilings and Figure 3 for T-bar ceilings.

Step 3: Adjust the nut on the bracket so that the boom of the bracket ring is flush with the ceiling. Complete the installation of the housing frame as shown in Figure 4.

Figure 2

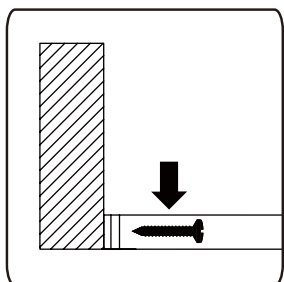

Wooden

Figure 3

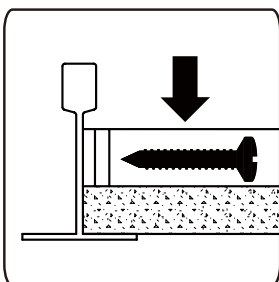

T-bar

Figure 1

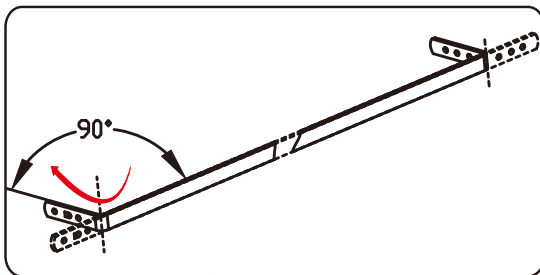

Figure 4

